

ShedGuide

The 8 × 6 Shed Plan

A free, buildable apex shed plan

Dimensioned drawings, a computed cut list, and the build sequence for the most popular size of garden shed in Britain.

Free from ShedGuide. Share it with anyone building a shed.

FLOOR PLAN — joists @ 400 mm c/c on 47x100 perimeter, 18 mm OSB3 deck

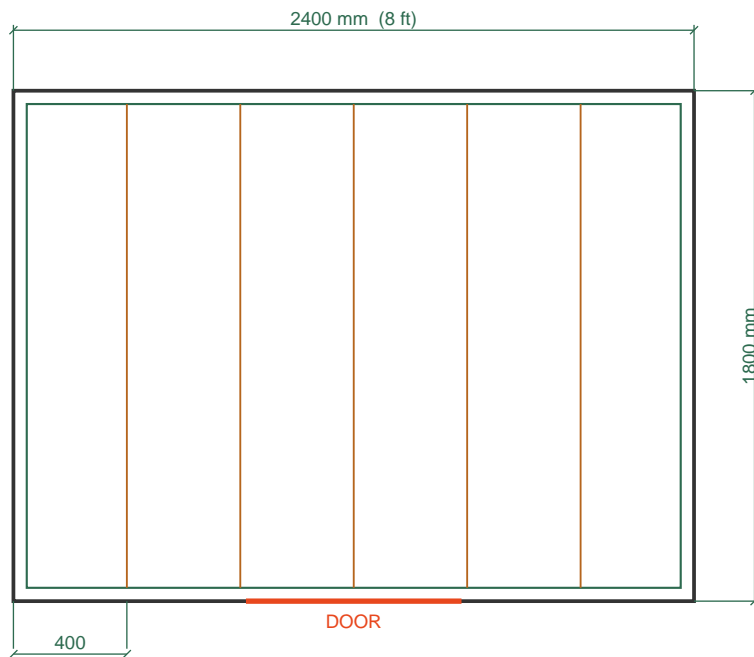

FRONT ELEVATION (gable end)

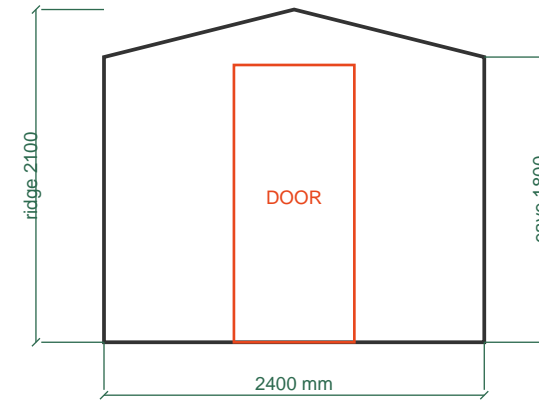

SIDE ELEVATION / WALL FRAMING — studs @ 600 mm c/c (47x75)

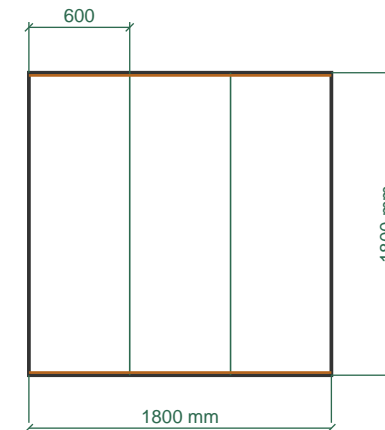

Cut list & materials — 8 × 6 ft apex shed

Computed from the dimensions drawn on the previous page. Buy ~10% extra timber for waste and the odd duff length. Sizes are nominal UK treated softwood.

Area	Material	Length / size	Qty	Notes
Floor	47 × 100 treated	1800 mm	8	Joists @ 400 c/c + 2 rim
Floor	OSB3 18 mm sheet	2440 × 1220	3	Floor deck (cut to fit)
Walls	47 × 75 treated	1800 mm	14	Wall studs @ 600 c/c (all 4 walls)
Walls	47 × 75 treated	2400 / 1800 mm	8	Top + sole plates (2 per wall)
Walls	47 × 75 treated	off-cuts	—	Noggins at mid-height
Roof	47 × 75 treated	1237 mm	8	Rafters (cut to 1237 mm, plumb both ends)
Roof	47 × 100 treated	1800 mm	1	Ridge board
Roof	OSB3 11 mm sheet	2440 × 1220	3	Roof deck
Roof	Mineral shed felt	8 / 10 m roll	1	20 mm overlap, clout-nailed
Cladding	Shiplap / featheredge	1800+ mm	—	≈ 15.1 m ² walls + gables (ask merchant)
Fixings	90 mm structural screws	—	200	Frame assembly
Fixings	50 mm screws	—	200	OSB to frame
Fixings	Galv. clout nails 13 mm	—	500	Felt

Build sequence

- 1. Base** — Level base 50 mm bigger than the footprint all round — paving slabs on a compacted MOT type-1 sub-base, or a 100 mm concrete slab. Check it's square (equal diagonals) and dead level before you build.
- 2. Floor** — Build the floor frame from 47×100, joists at the spacing on the plan. Square it, then screw down the 18 mm OSB3 deck. This becomes your work platform.
- 3. Walls** — Build each wall flat on the deck: sole plate, top plate, studs at the c/c shown, noggins at mid height, and a doubled stud each side of the door. Stand, plumb, brace, and screw to the floor and to each other at the corners.
- 4. Roof** — Fix the ridge board, then pairs of rafters cut to the length in the cut list (birdsmouth or plumb-cut to suit). Deck with 11 mm OSB3, overhang ~50 mm.
- 5. Weather** — Felt the roof with 20 mm laps, clout-nailed under the laps. Clad the walls (shiplap/featheredge), starting level at the bottom and working up.
- 6. Finish** — Hang the door, fit any window, then treat all timber. Two coats of spirit-based preserver or shed paint, and re-coat every couple of years.

Full step-by-step walkthroughs (with photos) for every stage are free at shedguide.co.uk — foundation, frame, roof, cladding, doors & windows and finishing.